

**MISSION STATEMENT:** "The City of Mound, through teamwork and cooperation, provides, at a reasonable cost, quality services that respond to the needs of all citizens, fostering a safe, attractive and flourishing community." "The Parks and Open Space Commission is an advisory body to the City Council. One of the Commission's functions is to hold public hearings and make recommendations to the City Council. The City Council makes all final decisions on these matters. Mound Ordinances require that certain documents and information be included in applications. The Parks and Open Space Commission may postpone consideration of an application that is incomplete and may for other reasons postpone final action on an application. For each agenda item, the Commission will receive reports prepared by the City Staff, open the hearing to the public, and discuss and act on the application."

**NOTE:** COMISSIONERS WILL BE CONTACTED BY STAFF PRIOR TO THE MEETINGS TO ASSESS ATTENDANCE. FAILURE TO RESPOND BY NOON ON THE DAY OF THE SCHEDULED MEETING WILL BE CONSIDERED AN ABSENCE AND MAY RESULT IN CANCELLATION OF THE MEETING DUE TO LACK OF A QUORUM. (952-472-0603 or admin@cityofmound.com)

## **PARKS AND OPEN SPACE COMMISSION**

### **AGENDA**

**7:00 P.M. Regular Meeting**  
**City Council Chambers**  
**5341 Maywood Road, Mound, MN**  
*Thursday, April 11, 2024*

	Page
1. Call to Order by Chair, Mark Stehlik	
2. Administer Oath of Office to Commissioner Mills	
3. Roll Call	
4. Approval of Agenda	
5. Approve minutes from 3-14-24 Meeting	1 – 2
6. Comments and Suggestions from Citizens Present (No more than 3 minutes allowed per speaker)	
7. Belmont Native Plant Proposal	3 – 20
8. 2024 Park and Open Spaces: Long Range Financial Plan: Capital Planning	21 - 22
9. Reports: Staff Updates City Council Representative Commissioner Comments	23
10. Adjourn	

**PARKS AND OPEN SPACE COMMISSION MEETING MINUTES**  
**March 14, 2024**

The Mound Parks and Open Spaces Commission met on Thursday, March 14, 2024, at 7:00pm in the Council Chambers at the Centennial Building.

Present: Chair Stehlik, Commissioners Blievernicht and Kahn, City Council Representative Pugh

Absent: Commissioner Mills

Others Present: City Manager Jesse Dickson

Public Present: Tyler Pieper

1. **Call to Order**

The meeting was called to order by Chair Stehlik at 7:00pm.

2. **Administer Oath of Office to Commissioner Mills**

Commissioner Mills was absent from the meeting; oath to be administered at April meeting.

3. **Roll Call**

Present: Chair Stehlik, Commissioners Blievernicht and Kahn, City Council Representative Pugh.

Absent: Commissioner Mills

4. **Approval of Agenda**

**Motion by Blievernicht, second by Kahn; Motion carried 4-0.**

5. **Approve Minutes from 1-11-24 Meeting**

Commissioner Kahn requested a correction to the "Selection of Chair and Vice Chair" portion of the 1-11-24 minutes to reflect that then-Chair Blievernicht was the Commissioner stepping down from Chair.

**Motion by Blievernicht to approve the minutes as amended, second by Kahn. Motion carried 4-0.**

6. **Comments and Suggestions from Citizens Present**

7. **Belmont Native Plant Proposal**

Tyler Pieper presented a plan to amend the Belmont Park native plant gardens that he is currently maintaining. After presentation and discussion, Commissioner Kahn requested Mr. Pieper speak with Public Works staff regarding the new tree in the existing garden and a reallocation of the plant beds near the current garden instead of near the road.

Mr. Pieper thanked the Commissioners and planned to resubmit an amended plan for Belmont Park for the POSC April meeting.

8. **Adopt a Greenspace Kick Off Discussion**

The Commissioners discussed the annual Adopt a Greenspace program. It was determined that there needs to be a system for checking in on current adopters to verify their continuing desire to stay in the program. Commissioner Blievernicht wondered what the role of the POSC is in park maintenance as it relates to the City Public Works Department.

The Commissioners agreed that receiving feedback from the Parks Department on its forms would be helpful going forward. Staff volunteered to begin reaching out to adopters.

9. **2024 Park and Open Spaces Project Priorities**

The Commissioners discussed priorities for the year. First, naming the park in conjunction with the City project in the Mound Harbor District. Second, the POSC would like to refine its general park change suggestion form to work in partnership with the Parks Department.

The Commissioners requested the park inventory portion of the City's CIP.

10. **2024 Spring Park Review Visits**

The Commissioners reviewed the list of parks that each is tasked with monitoring for the year, which are broken into five groups. It was determined that the Commission would wait to decide on moving to a two year system. The park groups were assigned as follows:

- A: Commissioner Blievernicht
- B: Commissioner Mills
- C: Commissioner Kahn
- D: City Council Member Pugh
- E: Chair Stehlik

11. **Reports**

12. **Adjourn**

**Motion by Commissioner Kahn to adjourn the meeting at 8:50pm, second by Commissioner Blievernicht. Motion carried 4-0.**

**CITY OF MOUND – CITY MANAGER**

2415 Wilshire Blvd  
Mound, MN 55364

**TO:** Parks and Open Spaces Commission

**FROM:** Maggie Reisdorf, Deputy City Manager

**DATE:** April 11, 2024

**SUBJECT:** Belmont Park – Native Garden Expansion

---

**REQUEST:**

To receive a presentation update from Tyler Pieper on the Belmont Park – Native Garden Expansion project.

**BACKGROUND:**

There are some city requested tasks and duties.

At the March 14, 2025 POSC meeting, Pieper presented a preliminary design to the Commission. At that meeting, they asked Pieper to connect with the Public Works Department on the presented location and come back to another meeting with an update.

**RECOMMENDATION:**

Staff is recommending listening to the presentation and providing feedback on the project.



# **Belmont Park** *Native Garden Expansion Proposals*

2024 - 2026 Plan

## Why Continue the Expansion?

- **Purpose:** Continue the native plant expansion into Belmont Park to help with beautifying the park for visitors, increase critical pollinator habitat, and (depending on the proposal chosen) provide a natural barrier to prevent children from entering traffic.
  - *Recommendation:* Plants with sturdy structure and height of no more than 3 ft will be used.
- **Plants to match conditions:** The site's first edition of native gardens thrived in a full-sun, dry soil setting, and accordingly, similar plants will be employed to maximize growth, assimilation into the site, and minimizing replacement.



# Plant Walls/Road Buffers Timeline

- *Email Proposal to City of Mound (Parks and Rec): April 2024*
- *Present Proposal to Parks and Rec: April 2024*
- *Site Clearing: Beginning of May 2024*
  - *Assistance from city required for clearing if possible.*
- *Planting of Natives: End of May 2024*
  - *Any plants that “don’t make it” will be replaced free of charge (not including rabbit/deer damage).*
- *Apply Mulch & Water: Early June 2024*
  - *From this plan, this would be the only item of cost for the City to handle.*
- *Weekly Weeding/Maintenance: 2024 – 2026*
  - *Tyler will cover this at a cost of \$00.00.*



# Road Buffer & Garden Expansion

## Order Plan:

- *Tyler Pieper will supply the City of Mound with an order for approximately \$700.00 (not including tax) worth of plants from Native Shoreline Technologies after approval of overall project. This vendor was also used in the first installations. The order will need to be placed in May to ensure end of May pick-up/delivery.*
- **Costs:**
  - *Plants = \$2.50 - \$3.50 per plant (230 plants for Approx. \$700)*
  - *City Services associated with mulch and water*



## *Plant Walls/Road Buffers Layout Design I*

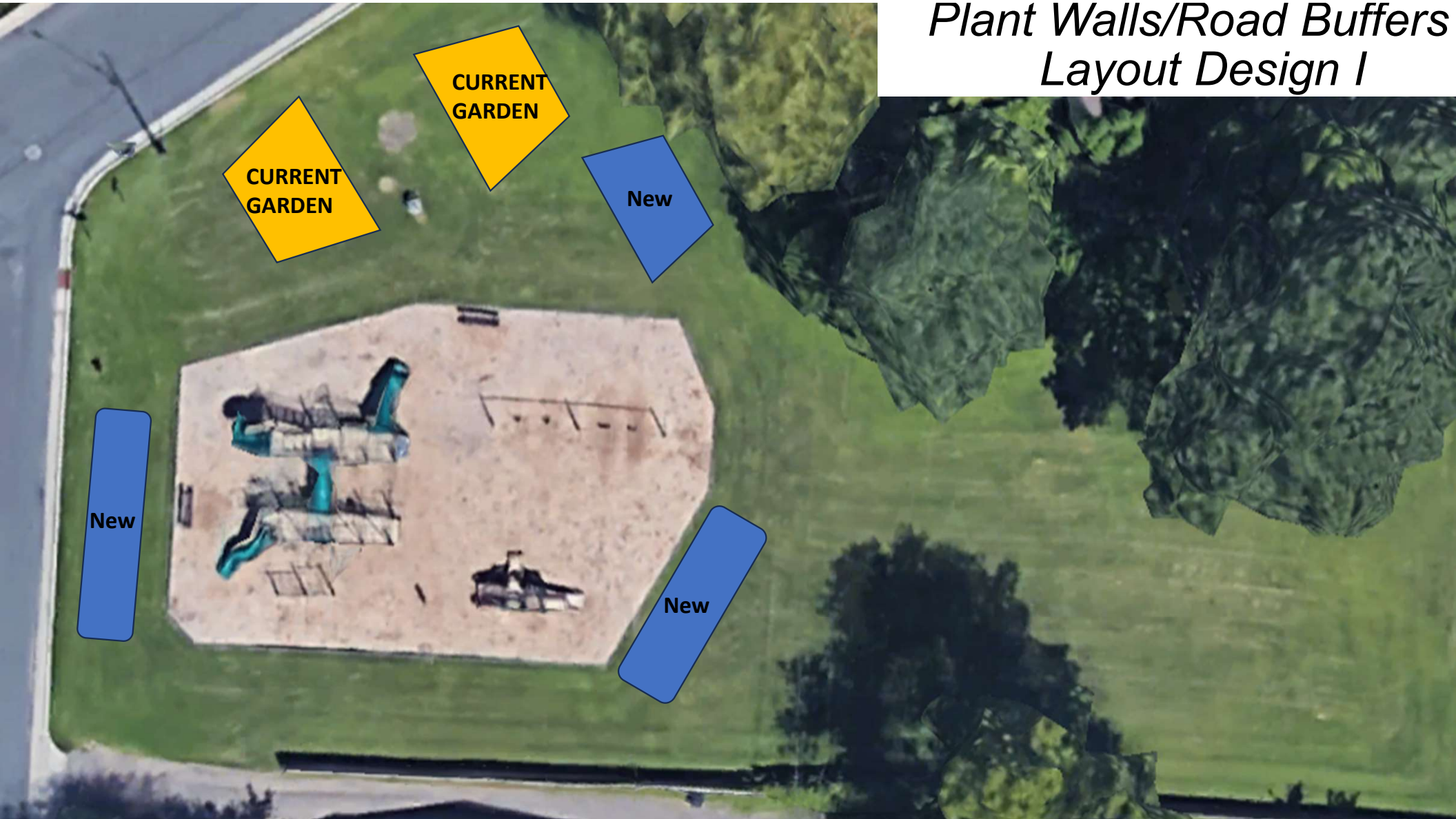



# Willow Tree Garden Layout (90 Plants)

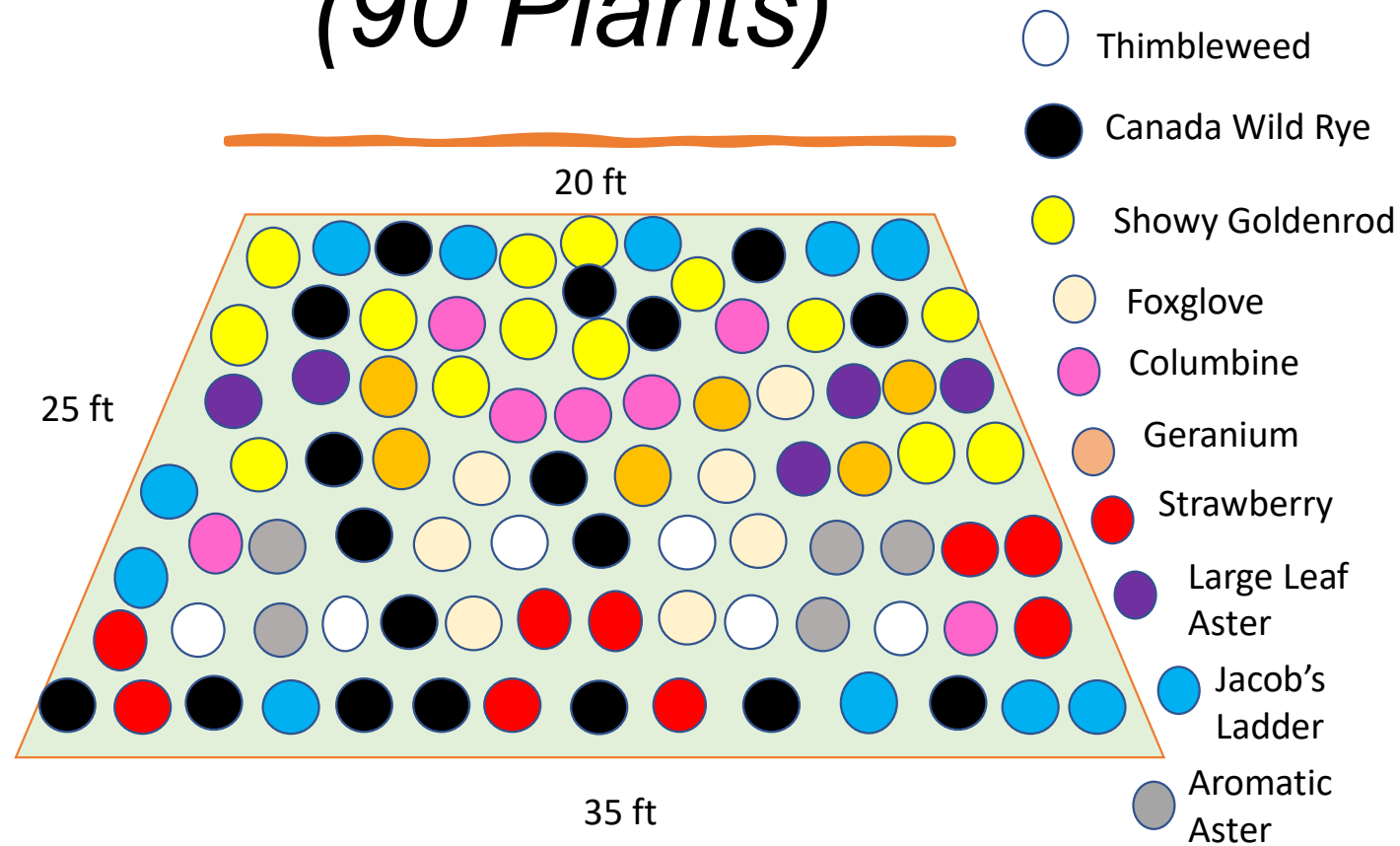



# Road Border Garden Layout (80 Plants)

- Wild Lupine
  Prairie Smoke
  Strawberry
  Blue Eyed Grass
  Stiff Goldenrod
- Little Blue Stem
  Rough Blazing Star
  Butterfly Weed
- Purple Prairie Clover
  Prairie Phlox
  Horse Mint

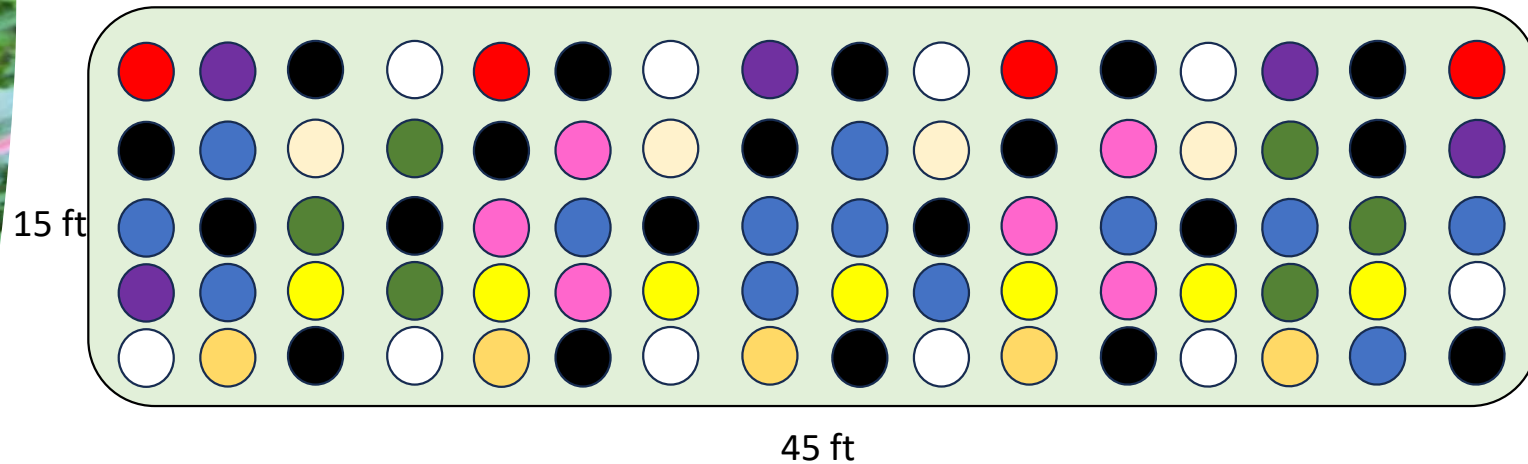



# East Border Garden Layout (60 plants total)

- |                    |                 |                      |                         |                  |
|--------------------|-----------------|----------------------|-------------------------|------------------|
| ○ Wild Lupine      | ● Prairie Smoke | ● Strawberry         | ○ Blue Eyed Grass       | ● Butterfly Weed |
| ● Little Blue Stem | ● Prairie Phlox | ● Rough Blazing Star | ● Purple Prairie Clover | ● Horse Mint     |
|                    |                 | ● Stiff Goldenrod    |                         |                  |

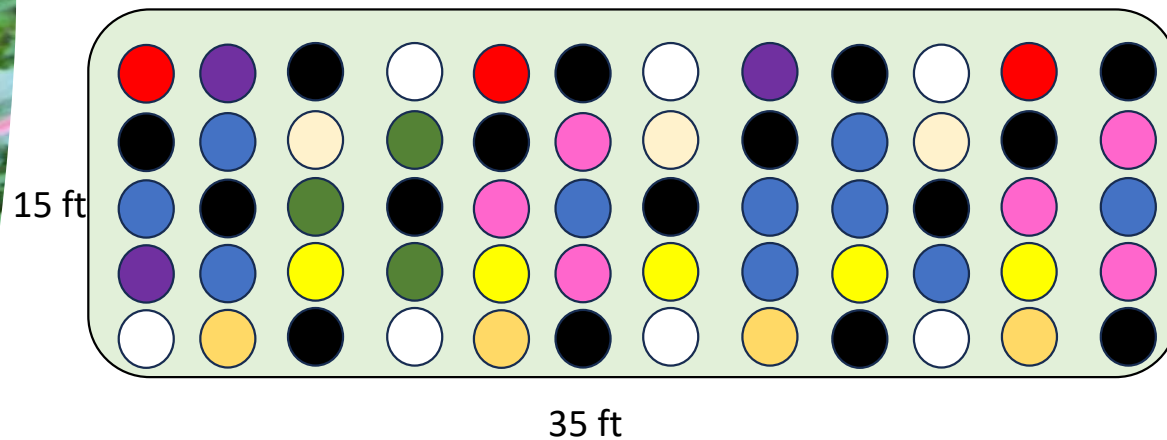

*Belmont Garden Expansion  
Layout Design 2*

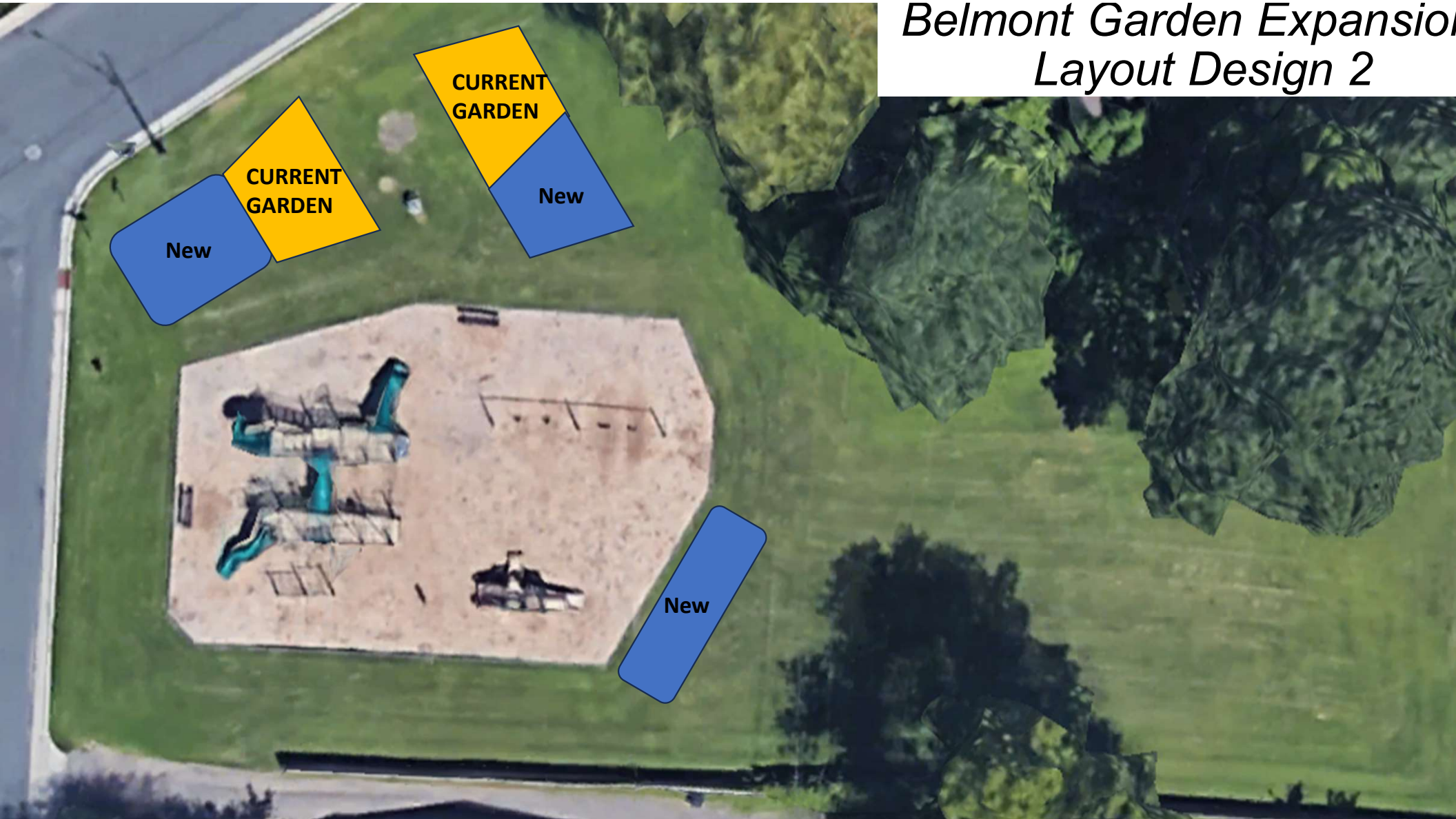



# Willow Tree Garden Layout (90 Plants)

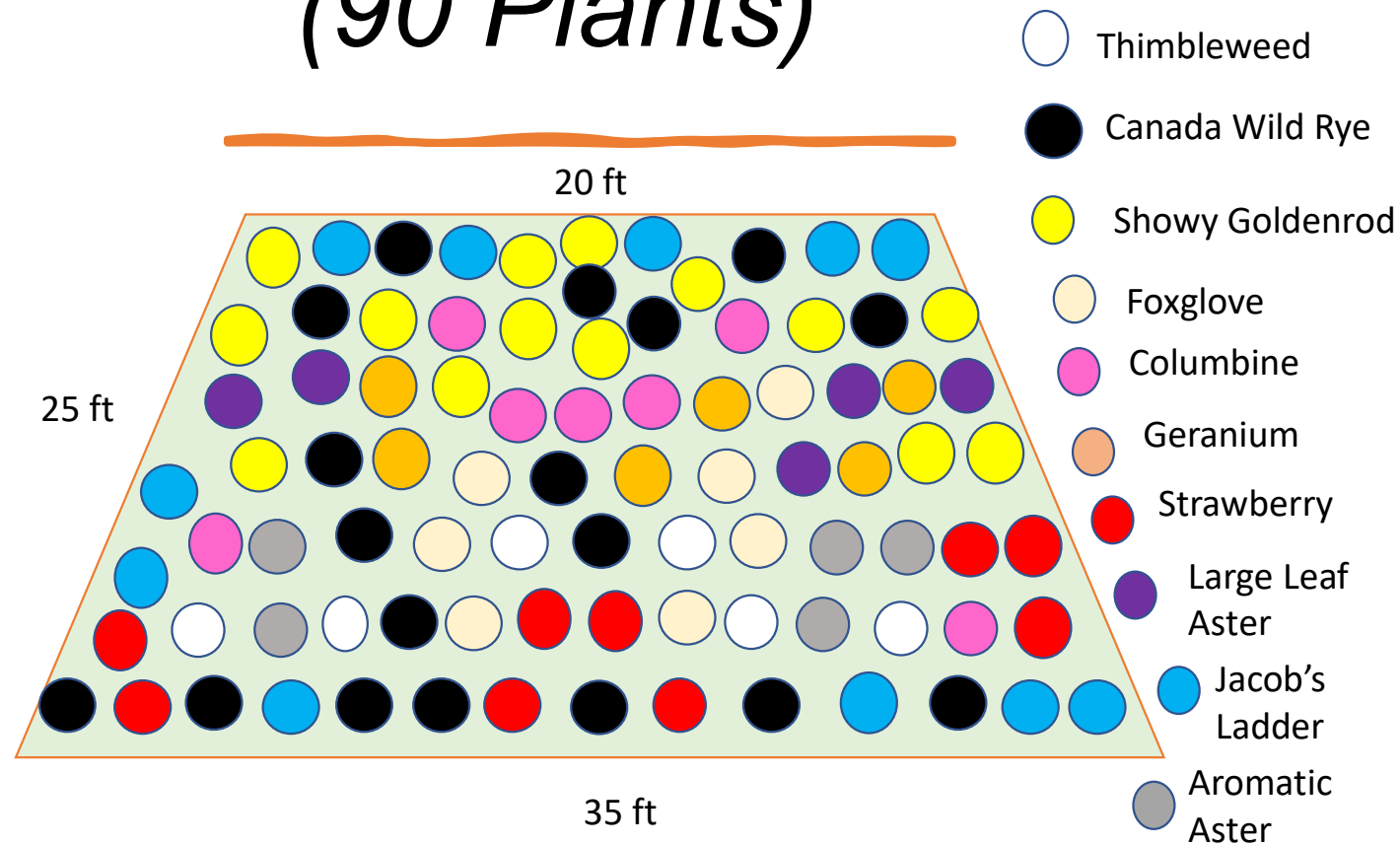



# Left Garden Layout (80 Plants)

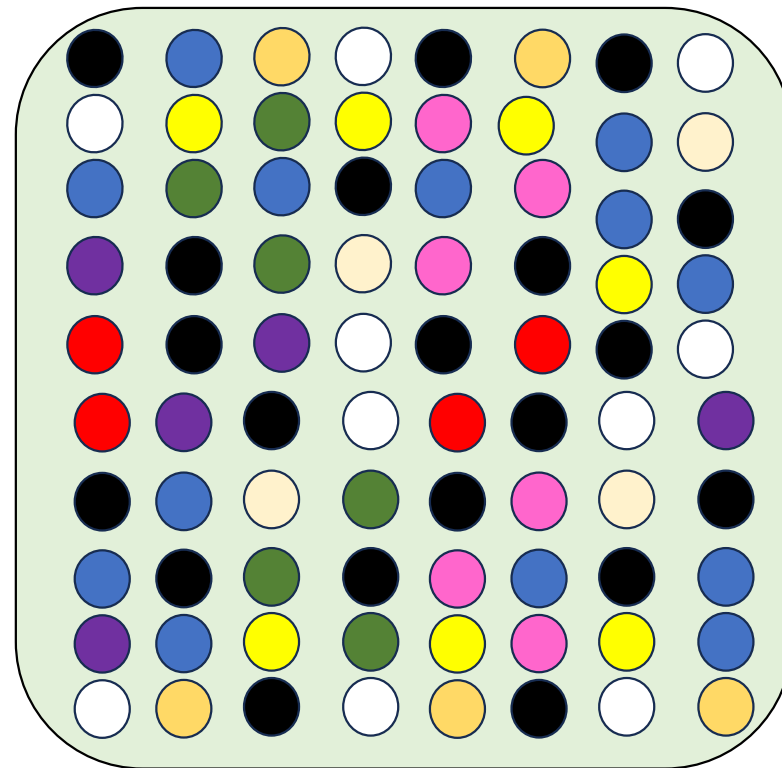

35 ft

25 ft

- Prairie Phlox
- Stiff Goldenrod
- Butterfly Weed
- Horse Mint
- Prairie Smoke
- Rough Blazing Star
- Strawberry
- Blue Eyed Grass
- Purple Prairie Clover
- Little Blue Stem
- Wild Lupine



# East Border Garden Layout (60 plants total)

- |                    |                 |                      |                         |                  |
|--------------------|-----------------|----------------------|-------------------------|------------------|
| ○ Wild Lupine      | ● Prairie Smoke | ● Strawberry         | ○ Blue Eyed Grass       | ● Butterfly Weed |
| ● Little Blue Stem | ● Prairie Phlox | ● Rough Blazing Star | ● Purple Prairie Clover | ● Horse Mint     |
|                    |                 | ● Stiff Goldenrod    |                         |                  |

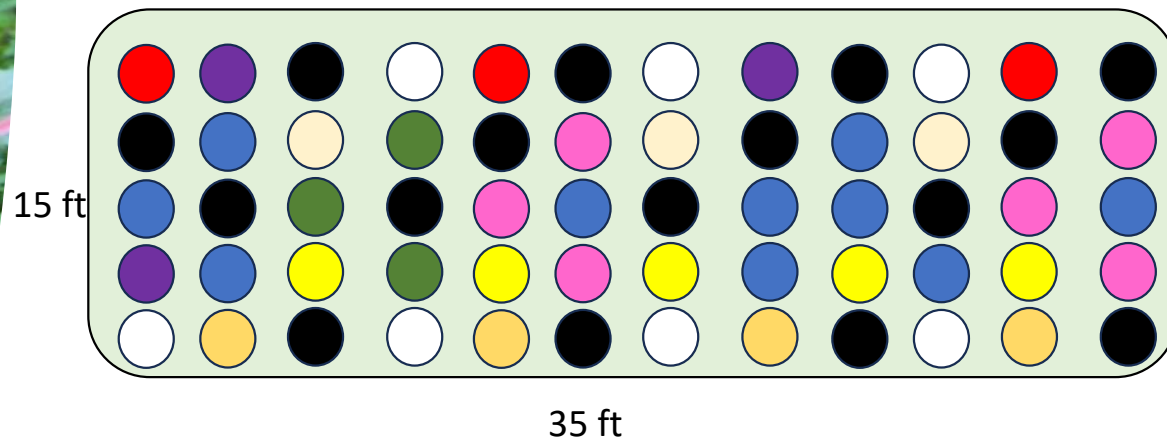



## Border Gardens Plant Selection...part I

- Wild Native Lupine (*Lupinus perennis*): 1 – 3 ft (May - June)

- Wild Lupine is the only host plant for the Karner Blue butterfly caterpillar. Habitat loss has led to the decline in plants, and put the Karner Blue on the endangered species list.



- Little Blue Stem (*Schizachyrium scoparium*): 1-3 ft (August – September)

- A pretty grass, Little Bluestem is another iconic species of prairies that once covered much of Minnesota. It is a host plant for several native butterflies and is popular in the garden trade as well as restoration projects.



- Prairie Smoke (*Geum triflorum*): 6-16 inches (April – June)

- Prairie Smoke is one of the first prairie flowers to bloom in the spring, a sign that the growing season has begun in Minnesota.



- Prairie Phlox (*Phlox pilosa*): 1-2 ft (May - June)

- Prairie Phlox adds a splash of shocking pink to prairies each June. It also does well in a garden, in sunny, sandy soil.

- Stiff Goldenrod (*Solidago rigida*): 1 – 5 ft (August – September)

- This species thrives in part-sun to full sun. The genus of “goldenrod” is actually one of the most beneficial plant species for insects, and has been regarded as a “keystone” species.





## Border Plant Selection...part II

- Wild Strawberry (*Fragaria virginiana*): 6 inches (April – June)

- It is a hardy plant that grows in a wide variety of sun/shade and soil conditions. Wild strawberry spreads rapidly by ground runners. Yes, you can eat it! The birds will love this.



- Rough Blazing Star (*Liatris aspera*): 1-3 ft (July - August)

- There are 5 species of Blazing Star native to Minnesota and one relatively easy way to tell similar species apart is by the floral bracts. Rough Blazing Star has round bracts with fringed edges that curl or fold in, and its flower heads have little or no stalk.



- Purple Prairie Clover (*Dalea purpea*): 10-20 inches (May – July)

- Purple Prairie Clover typically grows in clumps. When not flowering it looks similar to White Prairie Clover (*Dalea candida*), which is less clump-forming and has broader leaflets. It is a great plant for pollinators and does well in a sunny home garden in average to dry soil.



- Blue Eyed Grass (*Sisyrinchium montanum*): 5-20 inches (May-June)

- A small early season flower that maintains a small size while still being quite showy.

- Showy Goldenrod (*Solidago flexicaulis*): 1 – 3 ft (August – September)

- This species thrives in part-sun to full sun as long. The genus of “goldenrod” is actually one of the most beneficial plant species for insects, and has been regarded as a “keystone” species.



## Border Plant Selection...part III



- Butterfly Weed (*Asclepias tuberosa*): 6 inches (April – June)
  - A host plant for Monarch butterfly caterpillars, the flower is a favorite for many other butterflies as well. It makes a fantastic garden plant with a long bloom season and an eye-popping color you don't see in many species.



- Horse Mint (*Monarda punctata*): 1-3 ft (July - August)
  - Horsemint makes an excellent garden plant, doing well in both heavier soils and light hot sandy soils. Crushed leaves and seedheads both green and dried give off a wonderful pungent odor and which I've have loved as a potpourri.



- Purple Prairie Clover (*Dalea purpea*): 10-20 inches (May – July)
  - Purple Prairie Clover typically grows in clumps. When not flowering it looks similar to White Prairie Clover (*Dalea candida*), which is less clump-forming and has broader leaflets. It is a great plant for pollinators and does well in a sunny home garden in average to dry soil.

# Willow Garden Plant Selection...part I

- Aromatic Aster (*Symphyotrichum oblongifolium*): 1 – 3 ft (August – September)
  - This is one of the last flowers to bloom in late summer through fall. There is no floral scent, but the leaves give off a pleasant aroma when crushed, and is where the common name comes from.
- Large-Leaf Aster (*Erybia macrophylla*): 1-2 ft (August – September)
  - Usually just a few plants in the colony will send up flower stalks. Large-leaf aster is found in deciduous forests and open woods. Commonly seen in large clusters in Lake Maria State Park. New shoots were eaten like salad by the native peoples.
- Foxglove (*Penstemon digitalis*): 2- 5 ft (May - June)
  - Part shade/sun. I have found this to be a great one for the early June weeks when there is typically not a whole lot in bloom. This would be for the sunnier parts of the space.
- Wild Strawberry (*Fragaria virginiana*): 6 inches (April – June)
  - It is a hardy plant that grows in a wide variety of sun/shade and soil conditions. Wild strawberry spreads rapidly by ground runners. Yes, you can eat it! The birds will love this.
- Wild Geranium (*Geranium maculatum*): 1-3 ft (May - June)
  - Wild Geranium makes a wonderful part-sun/shade garden plant. It is easily distinguished from the other 3 Geranium species in Minnesota by its comparatively large flowers, an inch or more in diameter, where the others are under ½ inch.





## Willow Garden Plant Selection...part II

- Wild Geranium (*Geranium maculatum*): 1 – 2 ft (April – July)
  - Native to much of eastern North America, it never disappoints. It has lovely dissected leaves, beautiful pinkish-purple flowers, and it readily spreads, forming stunning patches that everything from bees to butterflies enjoy. Mostly found in woodlands in the wild, it does just as well in full sun.
- Native Columbine (*Aquilegia canadensis*): 1-3 ft (May - July)
  - Columbine, also called Red or American Columbine, is one of the first plants to provide nectar in the spring for bees, butterflies, and hummingbirds. Columbine is the larval host plant of the Columbine Duskywing. The colorful flowers are red flowing into yellow. Besides being an early bloomer, Columbine will tolerate a large range of soil and sun types, so you'll have success with it in full sun as well as shade. (*description from prairiemoon.com*)
- Jacob's Ladder (*Polemonium reptans*): 10-20 inches (May – July)
  - Jacob's ladder is a lovely spring wildflower with light blue bell-shaped flowers. The leaves are compound with the leaflets having a flattened appearance to look like the rungs of a ladder. It prefers shade but will grow in partial to full sun if it receives adequate moisture.
- Canada Wild Rye (*Elymus canadensis*): 2 -4 ft inches (June - August)
  - Canada wild rye is a cool-season, short-lived bunchgrass. Thick, bristly spikes appear in mid-summer often nodding with a bluish-green tint. All parts of the plant turn tan in the fall.
- Showy Goldenrod (*Solidago flexicaulis*): 1 – 3 ft (August – September)
  - This species thrives in part-sun to full sun. The genus of “goldenrod” is actually one of the most beneficial plant species for insects, and has been regarded as a “keystone” species.



**CITY OF MOUND – CITY MANAGER**

2415 Wilshire Blvd  
Mound, MN 55364

**TO:** Parks and Open Spaces Commission

**FROM:** Maggie Reisdorf, Deputy City Manager

**DATE:** April 11, 2024

**SUBJECT:** 2024 Parks and Open Space: Long Range Financial Plans:  
Capital Planning.

---

**REQUEST:**

To review and provide comment.

**BACKGROUND:**

Since 2023, the City has been working with an outside financial advising company, Ehlers, on a Long Term Financial Plan. This plan provides an outlook for the next 10 years an assumed operating and capital costs related to all city departments.

As part of the plan, staff has created a list of higher cost park capital items that need to be planned for and budget for over the next 10 years for maintenance or replacement. This includes items such as the replacement of playgrounds, upkeep of the Surfside Depot building, and more.

Included as an attachment is a draft version of these large capital items tentatively scheduled within the next 10 years.

**RECOMMENDATION:**

Staff is recommending review and discussion on this topic.

**ATTACHMENTS:**

DRAFT - Parks and Open Spaces 10-year Capital Plan.

CHANGE

**10-YEAR CAPITAL IMPROVEMENT PLAN (CIP): 2024-2033 (based on fall 2022 dollars)**  
**PARKS - NOT IN USE/PROJECTS ACCOUNTED FOR ELSEWHERE**  
 2/8/2024  
 (Includes 30% Indirect Cost)

LOCATION	FUNDING SOURCE	2024	2025	2026	2027	2028	2029	2030	2031	2032	2033	2034	2035+
Harbor District Park - Phase 1	(404)	\$746,000											
Harbor District Park - Phase 2	(404)		\$850,000										
Harbor District Park - Phase 3	(404)					\$626,000							
Surfside Park Playground <sup>(1)</sup>	(404)	\$220,000											
Chester Park			\$65,000										
Avon Park				\$95,000									
Dundee Park		\$10,000			\$80,000								
Philbrook - Little Tyke							\$25,000						
Highland Park							\$10,000				\$100,000		
Tyrone Park												\$110,000	
Belmont													-
Philbrook													
Rex Alwin													\$90,000
Swenson Park													\$110,000
Schervon Park												\$115,000	
Seton Park													-
Weiland Park													\$90,000
Three Points							\$150,000						\$110,000
Sorbo													\$100,000
Auditors Green Space	(404)												
<b>TOTALS</b>		<b>\$976,000</b>	<b>\$915,000</b>	<b>\$95,000</b>	<b>\$80,000</b>	<b>\$626,000</b>	<b>\$185,000</b>	<b>\$0</b>	<b>\$0</b>	<b>\$0</b>	<b>\$100,000</b>	<b>\$225,000</b>	<b>\$500,000</b>

<sup>(1)</sup> Does not include donated play equipment costs

**CITY OF MOUND – CITY MANAGER**

2415 Wilshire Blvd  
Mound, MN 55364

**TO:** Parks and Open Spaces Commission

**FROM:** Maggie Reisdorf, Deputy City Manager

**DATE:** April 11, 2024

**SUBJECT:** General Project Updates

---

**REQUEST:** Provided for information only

**BACKGROUND:**

2024 Adopt-A-Green Space Program:

- Staff has emailed (those we have emails for) and mailed (those we didn't have emails for) information about the Adopt-A-Green Space Program. The goal is to reconnect with volunteers and ask them how things are going.

2024 Park Visits:

- Annual Park Visit locations were decided at the March 2024 meeting. If you need evaluation forms, please let staff know.
- As part of the Annual Park Visits, the Public Works Parks Department will provide either a written follow up and/or verbal update at a POSC meeting on feedback/comments received from the visits.

Upcoming Community Events:

- Farmers Market: May 18 – October
- Spirit of the Lakes: July 12 – 13
- Music in the Park (Surfside): June 13, 2024, July 11, 2024, August 8, 2024
- Dog Days (Surfside): August 10, 2024

**RECOMMENDATION:**

Informational Only.

**Attachments:**

None.